

DBS

Chave de código / How to order

DBS (M) - (09)

→ Número de contatos / Number of contacts
09, 15, 25, 37, 50
→ M - Macho / Male
F - Fêmea / Female



Especificações / Specifications

Corrente máxima / Current rating	3 A
Tensão máxima / Voltage rating	125 VCA / VCC (VAC / VDC)
Resistência de contato máx. / Maximum contact resistance	15 m
Resistência de isolamento mín. / Minimum insulation resistance	5000 M (500 VCC / VDC)
Rigidez dielétrica / Withstanding voltage	1000 VCA / VAC (1 minuto / minute)
Temperatura de operação / Operate temperature range	-55°C a (to) +105°C
Material do isolador / Insulator material	PBT UL 94V-0 com fibra de vidro / Glass filled
Material do contato / Contact material	Latão dourado / Gold brass
Terminais / Terminals	Latão estanhado / Brass tin finished
Material da carcaça / Body material	Aço zincado / Steel, zinc plated
Cor do dielétrico / Dielectric color	Azul / Blue

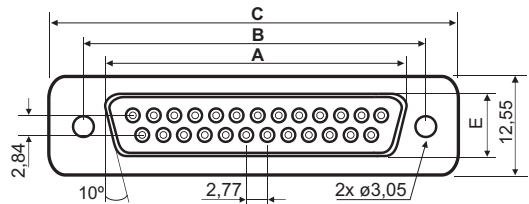
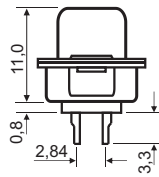
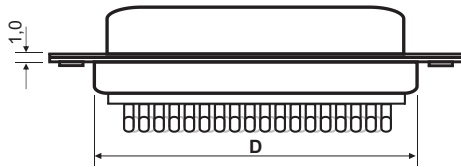
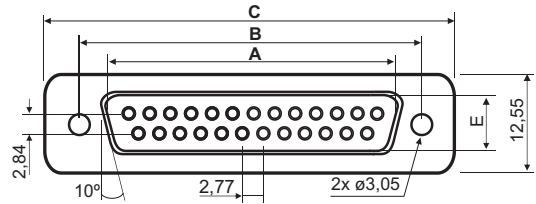
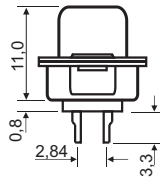
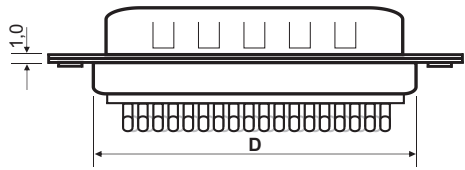

Nº de contatos Nº of contacts	Dimensões / Dimensions: mm					
	Macho Male	Fêmea Female	A	B	C	D
9	16,92	16,33	24,99	30,81	19,28	
15	25,25	24,66	33,32	39,14	27,51	
25	38,96	38,38	47,04	53,11	41,30	
37	55,42	54,84	63,50	69,32	57,71	
50	52,81	52,34	61,11	66,90	55,30	

E : 8,30 mm para conector macho / for female connector
7,90mm para conector fêmea / for male connector