



Features

- Match with precision potentiometer or other rotating devices
- Excellent legibility
- High Force and positive brake
- Standard model to fit 6mm or 6.35mm Diameter shaft

Technical Characteristics

Counting capacity, maximum turns	15
For shaft diameter	6mm or 6.35mm
For bushing diameter	9.53mm
Depth: maximum, from face of panel	22.86mm
Shaft Extension:	
Maximum, from face of panel	19.84mm
Minimum, from face of panel	15.95mm
Bushing Extension:	
Maximum, from face of panel	7.62mm
Locking mechanism	positive action with detent
Weight (nominal)	9 grams
Number of set screws	1
Number height	1.27mm
Knob material	Black Plastic
Dial finish	White Numerals on Satin Chrome
Housing finish	Satin Chrome
Operating temperature range	-55 to +85 DegreeC
Torque with brake engaged	550mN.m
Dial divisions	50 per turn

Outline Dimension

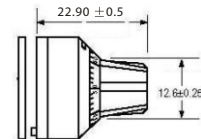
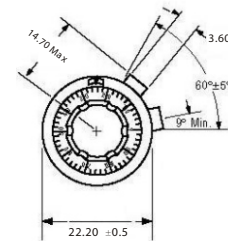

How to order

ZS - 2 2 - 15

A B C

A - Type

B - Diameter of housing: 22mm

C - Maximum turns : 15